

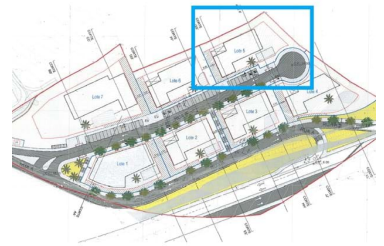

São Gonçalo de Lagos - Land



N/A
CLASSE
ENERGÉTICA

 **900**

Area (m²)

 **1613**

Land Area (m²)

1 100 000 €

(EUR €)

Prime Development Land for Sale in Lagos – Exceptional Investment Potential

Nestled in the heart of the Algarve, this premium development land in Lagos offers an incredible investment opportunity for those looking to build in one of Portugal's most sought-after regions. With ample space and a strategic location, this plot is ideal for residential or commercial development, catering to the region's growing demand for high-quality properties.

Lagos is a prime real estate destination, known for its stunning coastline, vibrant cultural scene, and excellent infrastructure. Whether you envision a luxury villa community, a boutique resort, or a modern apartment complex, this land provides the perfect canvas for your project. The area boasts easy access to major highways, essential services, and some of the Algarve's most beautiful beaches.



Elizabeth Freitas Pimenta

Owner & Interior Designer

+351966509048 ²

info@casaandkeyalgarve.com

T +351 966 509 079 ² · T +351 966 509 048 ² · E info@casaandkeyalgarve.com

Rua Drummond De Andrade Lote 26 1F Apartado 118 8500-610 Portimão
AMI 19463

¹ (Call to national fixed network) | ² (Call to national mobile network)



Your Logo Here
Friendly Real Estate

CKA77D

Reference

Scan the QR code to view the property



Portugal's property market continues to attract global investors, making this an ideal time to secure a development site with high appreciation potential. Don't miss out on this rare opportunity to create a standout project in Lagos.

Contact us today for more details or to schedule a site visit!

Property Features

- Energetic certification: Exempt
- Near Marina
- Near: Beach, Golf course, Shopping, Restaurants, City, Pharmacy, Schools
- Rustic land



Elizabeth Freitas Pimenta

Owner & Interior Designer

+351966509048 ²

info@casaandkeyalgarve.com

T +351 966 509 079 ² · T +351 966 509 048 ² · E info@casaandkeyalgarve.com
Rua Drummond De Andrade Lote 26 1F Apartado 118 8500-610 Portimão
AMI 19463

¹ (Call to national fixed network) | ² (Call to national mobile network)